



CHASE APARTMENTS
LONDON



Caro Point, Gatliff Road, Grosvenor Waterside, Sloane Square SW1W 8BD

£1,200,000

- 24/7 concierge
- underground parking
- private balcony
- minutes away from Battersea Park
- gym and spa
- air cooling
- on site nursery Purple Dragon
- west facing
- under floor heating
- minutes away from Sloane Square and Victoria stations

Grosvenor Waterside, 32 Gatliff Road, Belgravia, London, SW1W 8QN
02077225022

<http://www.chaseapartments.com/>

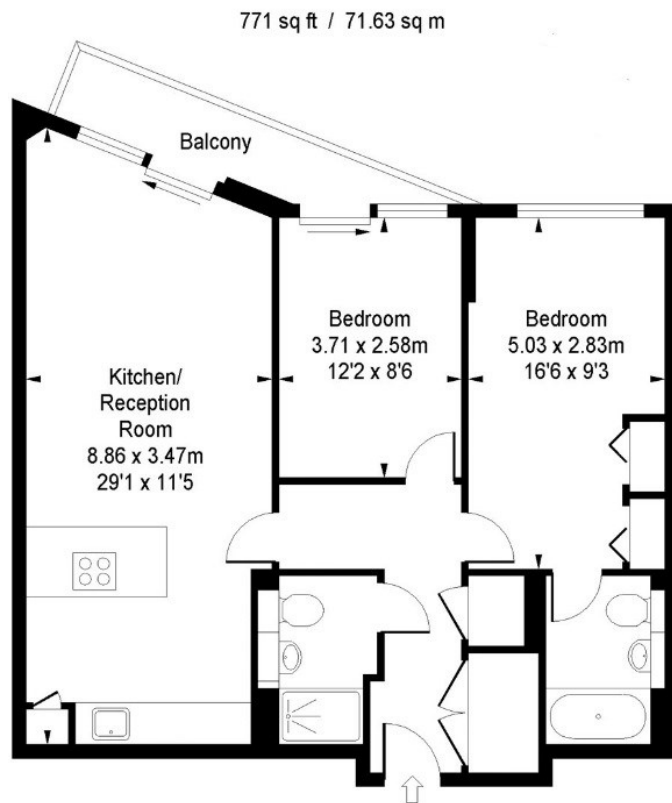

Viewings

Viewings by arrangement only.
Call 02077225022 to make an appointment.

Council Tax Band

E

EPC Rating:

B

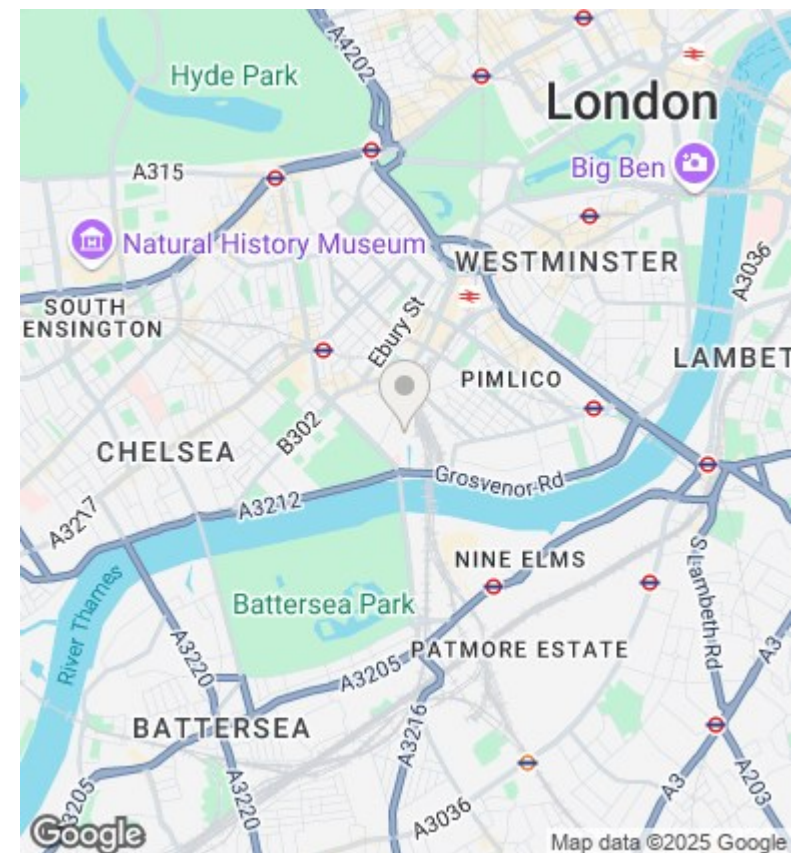

Energy Efficiency Rating		
	Current	Potential
Very energy efficient - lower running costs		
(92-plus) A		
(81-91) B	84	84
(69-80) C		
(55-68) D		
(39-54) E		
(21-38) F		
(1-20) G		
Not energy efficient - higher running costs		
England & Wales	EU Directive 2002/91/EC	